

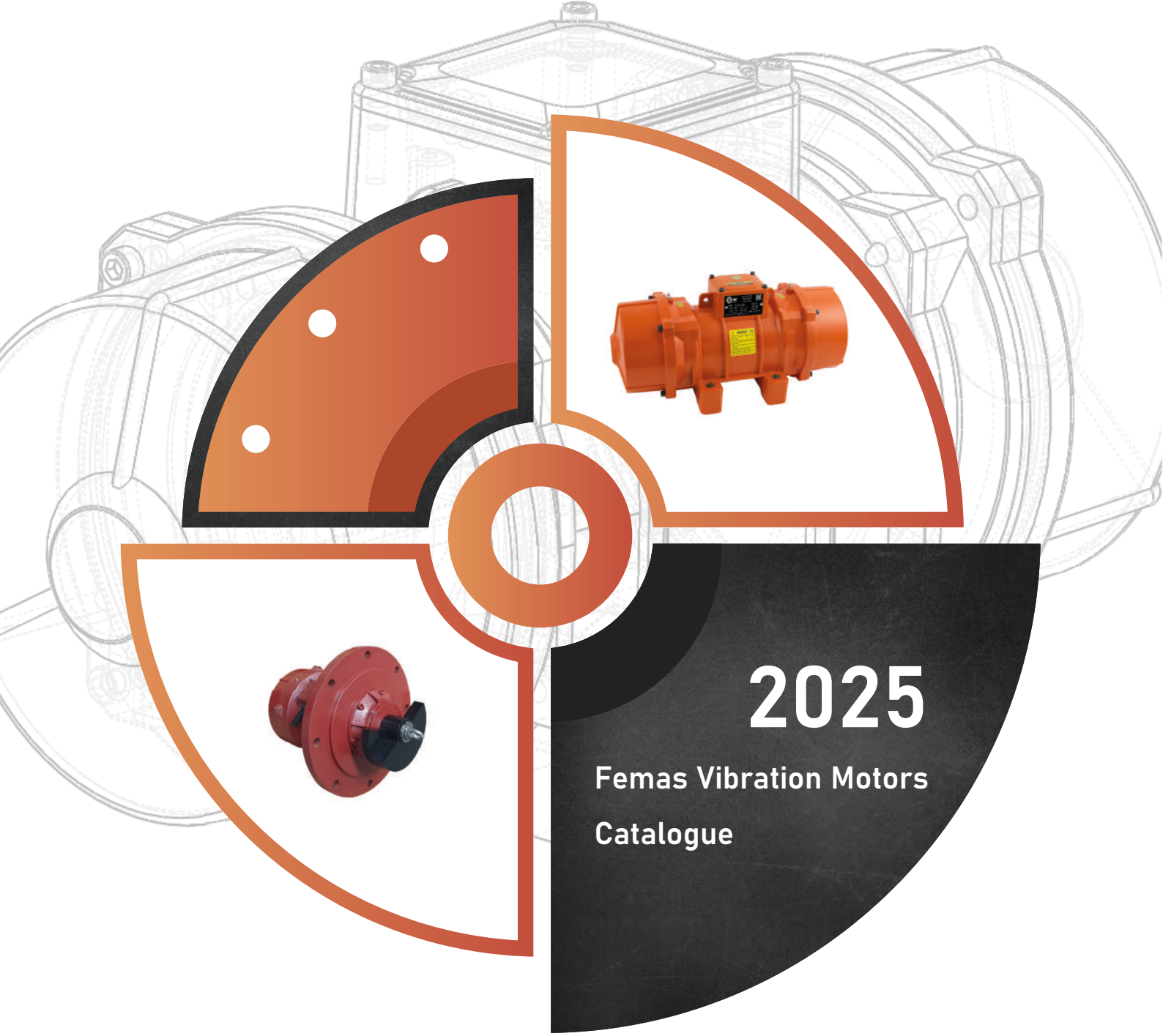

Since 1985



2025

**Femas Vibration Motors
Catalogue**



www.fvm.com.tr



HAKKIMIZDA

1985 yılından bu yana Aydın Astim OSB'de faaliyet gösteren FEMAŞ, vibrasyon teknolojilerinde 40 yıla ulaşan tecrübesiyle sektördeki liderliğini sürdürüyor. 200'den fazla güç ve model seçeneğiyle müşterilerine farklı çözümler sunan firma, sektördeki güçlü konumunu hızlı teslimat ve kaliteli üretimle pekiştiriyor. Endüstriyel uygulamaların ve titreşim enerjisine ihtiyaç duyulan pek çok alanın ihtiyaçlarını eksiksiz bir şekilde karşılayan FEMAŞ Vibrasyon Motorları; uzun çalışma ömrü, sağlam ve bakım gerektirmeyen tasarımı, üstün kalite, yüksek performans, enerji tasarrufu ve üstün sızdırmazlık özelliklerini bir araya getiriyor.

Vibrasyon motorlarını en zor şartlarda ve özel uygulamalarda dahi 7/24 çalışmayı sürdürecektir şekilde tasarlayan FEMAŞ, ürünlerinin bu yapısıyla; eleme, besleme ve yerleştirme işlemlerinde ilk tercih edilen markalar arasında yer alıyor. Yenilikçi çözümleri ve çok geniş portföyü ile vibrasyon motorlarında vazgeçilmez bir marka haline gelen FEMAŞ, yurt içindeki bayileriyle hızla büyürken; Avrupa, Amerika ve Orta Asya'da yer alan OEM müşterileri ve yurt dışı distribütörlük ağıyla küresel ölçekte de büyümeye ve gelişmeye devam ediyor. Her zaman daha iyiyi, daha kaliteli üretmenin heyecanı ile çalışarak, deneyimli kadrosundan aldığı sinerji ve müşteri odaklı çalışma anlayışıyla sektöre en sağlam, en güvenli ve en uygun olanı seçme imkanı sunan FEMAŞ, vibrasyon motoru sektöründe en iyi kaliteyi en uygun fiyata sunma mottosuyla çalışmalarını istikrarlı bir şekilde sürdürüyor.

ABOUT US

Operating in Aydın Astim Organized Industrial Zone since 1985, FEMAŞ continues to lead the industry with its 40 years of expertise in vibration technologies. Offering over 200 power and model options, the company strengthens its strong market position with fast delivery and high-quality production. FEMAŞ Vibration Motors fully meet the needs of industrial applications and various fields requiring vibration energy, combining long service life, robust and maintenance-free design, superior quality, high performance, energy efficiency, and excellent sealing properties.

Designing its vibration motors to operate 24/7 under the most challenging conditions and in special applications, FEMAŞ has become a top choice for screening, feeding, and positioning processes. With its innovative solutions and extensive product portfolio, FEMAŞ has become an indispensable brand in vibration motors. While rapidly expanding its domestic dealer network, it also continues to grow globally through its OEM customers in Europe, America, and Central Asia, as well as its international distributor network. Driven by the excitement of always producing better and higher quality products, FEMAŞ leverages the synergy of its experienced team and customer-oriented approach to offer the most durable, safest, and most suitable solutions in the industry. With a commitment to providing the best quality at the most competitive prices, FEMAŞ continues to maintain its steady growth in the vibration motor sector.



- Kaliteli, ekonomik ve özgün tasarım
- İyi müşteri ilişkileri yönetimi
- Kanıtlanmış yüksek kalite ve uzun ömür
- Enerji verimliliği yüksek çevre dostu motorları
- Farklı ihtiyaçlara yönelik çözümler sunan geniş ürün yelpazesi
- Esnek ve özelleştirilmiş üretim kabiliyetleri
- Dünya çapında bulunabilirlik ve güvenilirlik
- High-quality, economical, and original design
- Effective customer relationship management
- Proven high quality and long service life
- Energy-efficient and environmentally friendly motors
- A wide product range offering solutions for various needs
- Flexible and customized production capabilities
- Global availability and reliability.

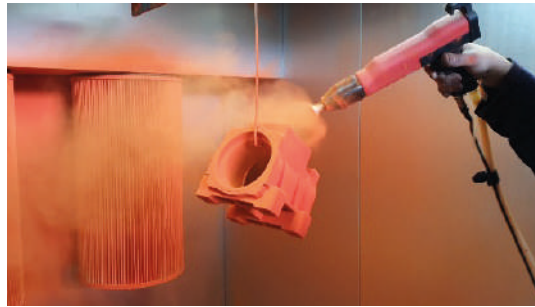
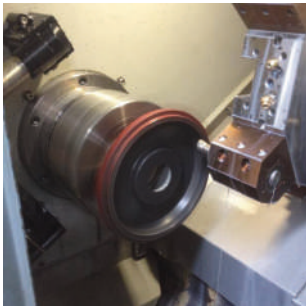

AC 3 Phase : 400V - 50 Hz

Rpm : 3000 Rpm

Safety Class : IP66

Insulation Class : F

Casing : Aluminum



ATEX 22 II 3D Ex tc IIIC T85°C Dc - IP66

FV Series

Model Type	Gövde Size	Statik Moment Static Moment	Santrifüj Kuvveti Centrifugal Force		Ağırlık Weight	Giriş Gücü Input Power	Nominal Akım Nom. Current
		kgmm	kgF	kN	kg	kW	A
FV 3/65	A0	6,4	64	0,63	6,1	0,15	0,30
FV 3/100	A0	10,3	103	1,01	6,2	0,15	0,32
FV 3/130	A0	13,7	138	1,36	6,5	0,18	0,34
FV 3/200	A0	19,9	200	1,97	6,6	0,18	0,35
FV 3/300	A	29,8	300	2,95	7,8	0,25	0,60
FV 3/330	A	33	333	3,27	7,9	0,25	0,65
FV 3/400	A	39,9	402	3,95	8,4	0,37	0,70
FV 3/500	B	49,7	500	4,91	10,4	0,45	0,80
FV 3/650	B	66	665	6,53	11,6	0,50	0,98
FV 3/760	B	77,3	778	7,64	11,7	0,55	1,00
FV 3/800	C	79,3	800	7,85	17,8	0,57	1,10
FV 3/850	C	85,5	861	8,45	18	0,60	1,20
FV 3/950	C	94,2	948	9,30	18,6	0,65	1,30
FV 3/1100	C	102,9	1037	10,18	18,8	0,75	1,50
FV 3/1300	C	129,1	1300	12,76	19,6	1,1	1,75

Working Moment = 2 X Static Moment

FV Serisi 3000 rpm. Vibrasyon motorları beton sıkıştırma, betonierler, filtre temizleme, gevşetme, boşaltma, ayıklama, dozajlama gibi titreşim hareketinin gerektiği tüm alanlarda kullanılır.

FV Series 3000 rpm vibration motors are used in all areas where vibration motion is required, such as concrete compaction, concrete mixers, filter cleaning, loosening, discharging, sorting, and dosing.

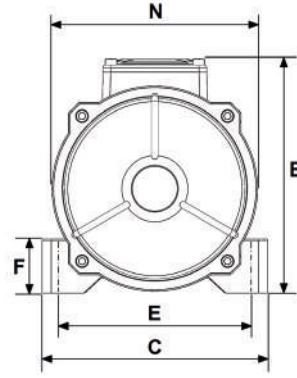
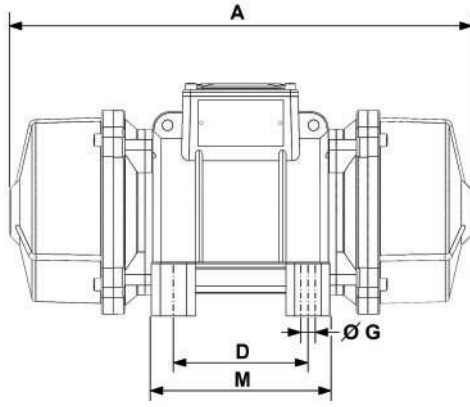

ATEX 22 II 3D Ex tc IIIC T85°C Dc - IP66

FV Series

Model Type	Gövde Size	Gövde Ölçüleri - Overall Dimensions (mm)									
		A	B	C	D	E	Ø G	F	M	N	Rakor Cable gland
FV 3/65	A0	222	161	126	62-74	106	4 X M8	15	103	120	M16 X 1,5
FV 3/100	A0	222	161	126	62-74	106	4 X M8	15	103	120	M16 X 1,5
FV 3/130	A0	222	161	126	62-74	106	4 X M8	15	103	120	M16 X 1,5
FV 3/200	A0	222	161	126	62-74	106	4 X M8	15	103	120	M16 X 1,5
FV 3/300	A	255	159	155	90	125	4 X M12	36	122	135	M20 X 1,5
FV 3/330	A	255	159	155	90	125	4 X M12	36	122	135	M20 X 1,5
FV 3/400	A	255	159	155	90	125	4 X M12	36	122	135	M20 X 1,5
FV 3/500	B	350	184	175	105	140	4 X M12	42	140	160	M20 X 1,5
FV 3/650	B	350	184	175	105	140	4 X M12	42	140	160	M20 X 1,5
FV 3/760	B	350	184	175	105	140	4 X M12	42	140	160	M20 X 1,5
FV 3/800	C	394	209	210	120	170	4 X M16	48	160	180	M20 X 1,5
FV 3/850	C	394	209	210	120	170	4 X M16	48	160	180	M20 X 1,5
FV 3/950	C	394	209	210	120	170	4 X M16	48	160	180	M20 X 1,5
FV 3/1100	C	394	209	210	120	170	4 X M16	48	160	180	M20 X 1,5
FV 3/1300	C	394	209	210	120	170	4 X M16	48	160	180	M20 X 1,5

AC 3 Phase : 400V - 50 Hz

Rpm : 3000 Rpm

Safety Class : IP66

Insulation Class : F

Casing : Cast Iron



ATEX 22 II 3D Ex tc IIIC T85°C Dc - IP66

FV Series

Model Type	Gövde Size	Statik Moment Static Moment	Santrifüj Kuvveti Centrifugal Force		Ağırlık Weight	Giriş Gücü Input Power	Nominal Akım Nom. Current
		kgmm	kgF	kN	kg	kW	A
FV 3/1600	D	163,4	1645	16,14	44	1,5	2,30
FV 3/1800	D	179,8	1810	17,76	44,5	2	2,60
FV 3/2000	D	195,6	1970	19,33	45	2,2	3,30
FV 3/2300	D	224,6	2262	22,19	46	2,4	3,50
FV 3/2500	EO	263,9	2660	26,1	70	2,5	3,80
FV 3/2850	EO	282,5	2847	27,93	71	3	4,50
FV 3/3300	EO	331,8	3344	32,81	75	3,5	5,10
FV 3/4000	E	399,4	4022	39,46	85	4	6,50
FV 3/5000	E	497,6	5016	49,21	87	5,5	8,20
FV 3/6500	F	613,6	6565	64,41	125	7,5	12,50
FV 3/7600	F	683,2	7310	71,72	127	9	15,00
FV 3/9000	F	834,2	9014	88,43	135	10	17,00

Working Moment = 2 X Static Moment

FV Serisi 3000 rpm. Vibrasyon motorları beton sıkıştırma, betonyerler, filtre temizleme, gevşetme, boşaltma, ayıklama, dozajlama gibi titreşim hareketinin gerektiği tüm alanlarda kullanılır.

FV Series 3000 rpm vibration motors are used in all areas where vibration motion is required, such as concrete compaction, concrete mixers, filter cleaning, loosening, discharging, sorting, and dosing.

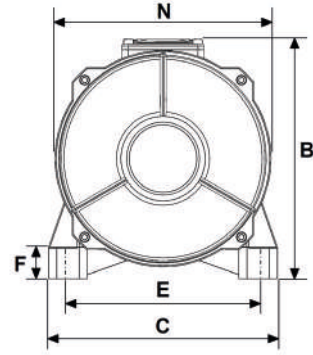
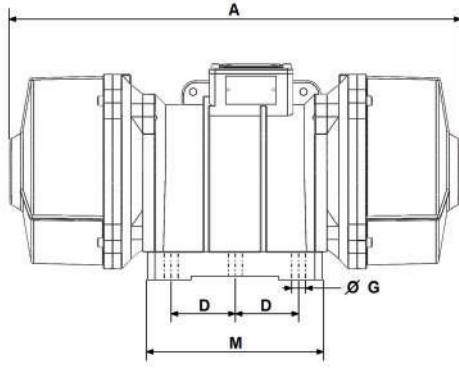

ATEX 22 II 3D Ex tc IIIC T85°C Dc - IP66

FV Series

Model Type	Gövde Size	Gövde Ölçüleri - Overall Dimensions (mm)									
		A	B	C	D	E	Ø G	F	M	N	Rakor Cable gland
FV 3/1600	D	450	245	233	140	190	4 X M16	33	190	209	M20 X 1,5
FV 3/1800	D	450	245	233	140	190	4 X M16	33	190	209	M20 X 1,5
FV 3/2000	D	450	245	233	140	190	4 X M16	33	190	209	M20 X 1,5
FV 3/2300	D	450	245	233	140	190	4 X M16	33	190	209	M20 X 1,5
FV 3/2500	E0	560	260	271	155	225	4 X M20	68	204	244	M25 X 1,5
FV 3/2850	E0	560	260	271	155	225	4 X M20	68	204	244	M25 X 1,5
FV 3/3300	E0	560	260	271	155	255	4 X M20	68	204	244	M25 X 1,5
FV 3/4000	E	590	283	297	155	255	4 X M20	68	208	255	M25 X 1,5
FV 3/5000	E	590	283	297	155	255	4 X M20	68	208	255	M25 X 1,5
FV 3/6500	F	680	345	385	100 x 2	320	4 X M27	50	270	345	M25 X 1,5
FV 3/7600	F	680	345	385	100 x 2	320	4 X M27	50	270	345	M25 X 1,5
FV 3/9000	F	680	345	385	100 x 2	320	4 X M27	50	270	345	M25 X 1,5

AC 3 Phase : 400V - 50 Hz

Rpm : 1500 Rpm

Safety Class : IP66

Insulation Class : F

Casing : Aluminum



ATEX 22 II 3D Ex tc IIIC T85°C Dc - IP66

FV Series

Model Type	Gövde Size	Statik Moment Static Moment	Santrifüj Kuvveti Centrifugal Force		Ağırlık Weight	Giriş Gücü Input Power	Nominal Akım Nom. Current
		kgmm	kgF	kN	kg	kW	A
FV 15/20	A0	9,9	25	0,25	6	0,09	0,19
FV 15/30	A0	13,5	34	0,34	6,4	0,09	0,20
FV 15/60	A0	24,2	61	0,60	6,6	0,09	0,20
FV 15/90	A0	33,4	93	0,92	7,1	0,09	0,21
FV 15/200	A	67,1	169	1,66	9,8	0,18	0,42
FV 15/300	B	122,2	308	3,02	12,7	0,27	0,55
FV 15/400	B	167	421	4,13	15,6	0,37	0,70
FV 15/520	B	206	519	5,09	18,6	0,40	0,80
FV 15/650	C	259	652	6,40	24,2	0,45	0,90
FV 15/750	C	302	761	7,47	25,7	0,55	0,95

Working Moment = 2 X Static Moment

FV Serisi 1500 rpm. Vibrasyon motorları ayırma, yükleme, eleme, dozajlama, konumlama, sınıflandırma, besleme, gevşetme, boşaltma gibi titreşim hareketinin gerektiği tüm alanlarda kullanılır.

FV Series 1500 rpm vibration motors are used in all areas where vibration motion is required, such as separation, loading, screening, dosing, positioning, classification, feeding, loosening, and discharging.

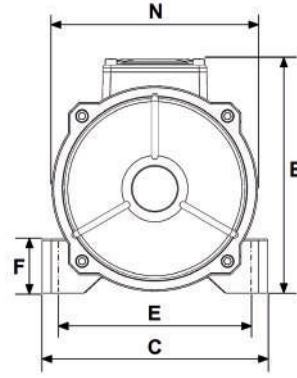
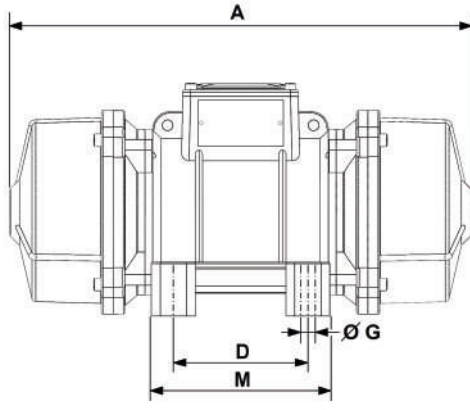

ATEX 22 II 3D Ex tc IIIC T85°C Dc - IP66

FV Series

Model Type	Gövde Size	Gövde Ölçüleri - Overall Dimensions (mm)									
		A	B	C	D	E	Ø G	F	M	N	Rakor Cable gland
FV 15/20	A0	222	161	126	62-74	106	4 X M8	15	103	120	M16 X 1,5
FV 15/30	A0	222	161	126	62-74	106	4 X M8	15	103	120	M16 X 1,5
FV 15/60	A0	222	161	126	62-74	106	4 X M8	15	103	120	M16 X 1,5
FV 15/90	A0	222	161	126	62-74	106	4 X M8	15	103	120	M16 X 1,5
FV 15/200	A	296	159	155	90	125	4 X M12	36	122	135	M20 X 1,5
FV 15/300	B	350	184	175	105	140	4 X M12	42	140	160	M20 X 1,5
FV 15/400	B	390	184	175	105	140	4 X M12	42	140	160	M20 X 1,5
FV 15/520	B	390	184	175	105	140	4 X M12	42	140	160	M20 X 1,5
FV 15/650	C	437	209	210	120	170	4 X M16	48	160	180	M20 X 1,5
FV 15/750	C	437	209	210	120	170	4 X M16	48	160	180	M20 X 1,5

AC 3 Phase : 400V - 50 Hz

Rpm : 1500 Rpm

Safety Class : IP66

Insulation Class : F

Casing : Cast Iron



ATEX 22 II 3D Ex tc IIIC T85°C Dc - IP66

FV Series

Model Type	Gövde Size	Statik Moment Static Moment	Santrifüj Kuvveti Centrifugal Force		Ağırlık Weight	Giriş Gücü Input Power	Nominal Akım Nom. Current
		kgmm	kgF	kN	kg	kW	A
FV 15/1300	D	529	1332	13,07	50	0,75	1,35
FV 15/1500	D	605	1524	14,95	56	0,95	1,50
FV 15/1800	D	681	1715	17,59	57	1,1	2,00
FV 15/2000	D	817	2060	20,21	63	1,3	2,30
FV 15/2450	EO	940	2368	23,23	75	1,5	2,60
FV 15/2700	EO	1055	2660	26,1	81	1,7	3,20
FV 15/3100	EO	1210	3049	29,91	85	2	3,50
FV 15/3500	E	1388	3498	34,32	101	2,1	3,85
FV 15/3800	E	1543	3888	38,14	105	2,2	3,90
FV 15/4300	E	1698	4278	41,97	115	3	5,10
FV 15/5000	F	1985	5001	49,06	170	3,5	6,00
FV 15/6000	F	2383	6003	58,89	185	4	7,60
FV 15/7000	F	2780	7005	68,72	196	5,5	10,50
FV 15/7900	F	3177	8007	78,55	204	7	11,60
FV 15/9500	G	3742	9428	92,49	385	7,5	12,20

Working Moment = 2 X Static Moment

FV Serisi 1500 rpm. Vibrasyon motorları ayırma, yükleme, eleme, dozajlama, konumlama, sınıflandırma, besleme, gevşetme, boşaltma gibi titreşim hareketinin gerektiği tüm alanlarda kullanılır.

FV Series 1500 rpm vibration motors are used in all areas where vibration motion is required, such as separation, loading, screening, dosing, positioning, classification, feeding, loosening, and discharging.

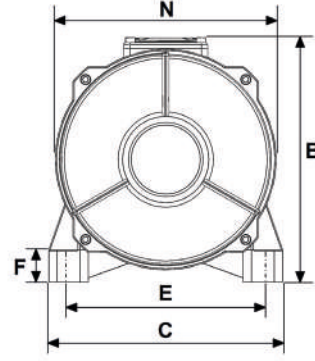
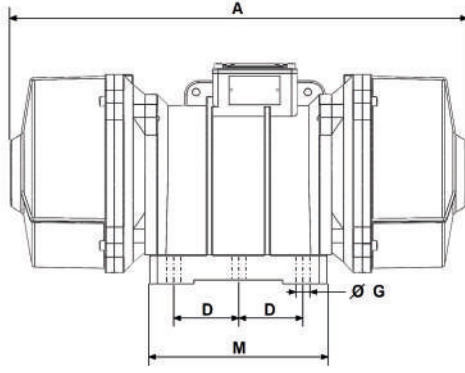

ATEX 22 II 3D Ex tc IIIC T85°C Dc - IP66

FV Series

Model Type	Gövde Size	Gövde Ölçüleri - Overall Dimensions (mm)									
		A	B	C	D	E	Ø G	F	M	N	Rakor Cable gland
FV 15/1300	D	450	245	233	140	190	4 X M16	33	190	209	M20 X 1,5
FV 15/1500	D	500	245	233	140	190	4 X M16	33	190	209	M20 X 1,5
FV 15/1800	D	500	245	233	140	190	4 X M16	33	190	209	M20 X 1,5
FV 15/2000	D	570	245	233	140	190	4 X M16	33	190	209	M20 X 1,5
FV 15/2450	E0	560	260	271	155	225	4 X M20	68	204	244	M25 X 1,5
FV 15/2700	E0	560	260	271	155	225	4 X M20	68	204	244	M25 X 1,5
FV 15/3100	E0	560	260	271	155	225	4 X M20	68	204	244	M25 X 1,5
FV 15/3500	E	590	283	297	155	255	4 X M20	68	208	255	M25 X 1,5
FV 15/3800	E	590	283	297	155	255	4 X M20	68	208	255	M25 X 1,5
FV 15/4300	E	650	283	297	155	255	4 X M20	68	208	255	M25 X 1,5
FV 15/5000	F	680	345	385	100 X 2	320	4 X M27	50	270	345	M25 X 1,5
FV 15/6000	F	680	345	385	100 X 2	320	4 X M27	50	270	345	M25 X 1,5
FV 15/7000	F	680	345	385	100 X 2	320	4 X M27	50	270	345	M25 X 1,5
FV 15/7900	F	680	345	385	100 X 2	320	4 X M27	50	270	345	M25 X 1,5
FV 15/9500	G	830	390	470	125 X 2	380	4 X M36	38	370	385	M25 X 1,5

AC 3 Phase : 400V - 50 Hz

Rpm : 1000 Rpm

Safety Class : IP66

Insulation Class : F

Casing : Aluminum



ATEX 22 II 3D Ex tc IIIC T85°C Dc - IP66

FV Series

Model Type	Gövde Size	Statik Moment Static Moment	Santrifüj Kuvveti Centrifugal Force		Ağırlık Weight	Giriş Gücü Input Power	Nominal Akım Nom. Current
		kgmm	kgF	kN	kg	kW	A
FV 10/200	B	168	188	1,84	17,4	0,18	0,50
FV 10/270	B	205	230	2,26	19,5	0,25	0,60
FV 10/390	C	304	340	3,34	25,6	0,35	0,70

Working Moment = 2 X Static Moment

FV Serisi 1000 rpm. Vibrasyon motorları ayırma, yükleme, eleme, dozajlama, konumlama, sınıflandırma, besleme, gevşetme, boşaltma gibi titreşim hareketinin gerektiği tüm alanlarda kullanılır.

FV Series 1000 rpm vibration motors are used in all areas where vibration motion is required, such as separation, loading, screening, dosing, positioning, classification, feeding, loosening, and discharging.

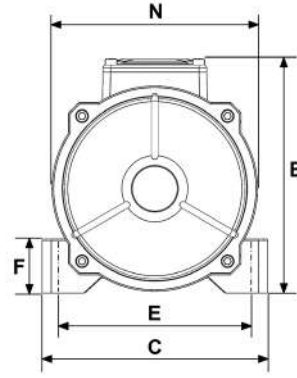
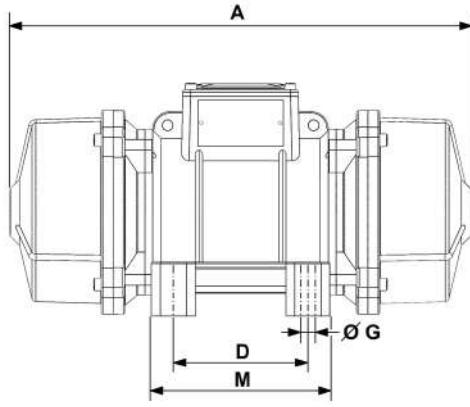

ATEX 22 II 3D Ex tc IIIC T85°C Dc - IP66

FV Series

Model Type	Gövde Size	Gövde Ölçüleri - Overall Dimensions (mm)									
		A	B	C	D	E	Ø G	F	M	N	Rakor Cable gland
FV 10/200	B	390	184	175	105	140	4 X M12	42	140	160	M20 X 1,5
FV 10/270	B	390	184	175	105	140	4 X M12	42	140	160	M20 X 1,5
FV 10/390	C	437	209	210	120	170	4 X M16	48	160	180	M20 X 1,5

AC 3 Phase : 400V - 50 Hz

Rpm : 1000 Rpm

Safety Class : IP66

Insulation Class : F

Casing : Cast Iron



ATEX 22 II 3D Ex tc IIIC T85°C Dc - IP66

FV Series

Model Type	Gövde Size	Statik Moment Static Moment	Santrifüj Kuvveti Centrifugal Force		Ağırlık Weight	Giriş Gücü Input Power	Nominal Akım Nom. Current
		kgmm	kgF	kN	kg	kW	A
FV 10/750	D	682	763	7,49	55	0,55	1,00
FV 10/810	D	758	848	8,32	62	0,65	1,30
FV 10/1100	D	909	1018	9,99	65	0,75	1,45
FV 10/1700	E0	1481	1658	16,26	88	1,1	2,20
FV 10/2000	E0	1751	1961	19,24	95	1,5	2,80
FV 10/2600	E	2317	2595	25,52	130	2	4,35
FV 10/3800	F	3359	3762	36,91	190	2,3	4,60
FV 10/4500	F	3920	4390	46,16	204	2,5	5,00
FV 10/5000	F	4350	4871	51,21	218	3	6,20
FV 10/5700	F	4973	5569	54,64	221	3,5	8,00
FV 10/6000	F	5284	5917	58,04	226	4	8,10
FV 10/6500	F	5503	6163	60,46	227	4,5	8,60
FV 10/7000	F	5961	6676	68,03	247	5,5	9,50
FV 10/8500	G	7488	8386	82,27	360	7,5	14,00
FV 10/10000	G	8559	9585	99,91	385	8,5	15,00

Working Moment = 2 X Static Moment

FV Serisi 1000 rpm. Vibrasyon motorları ayırma, yükleme, eleme, dozajlama, konumlama, sınıflandırma, besleme, gevşetme, boşaltma gibi titreşim hareketinin gerektiği tüm alanlarda kullanılır.

FV Series 1000 rpm vibration motors are used in all areas where vibration motion is required, such as separation, loading, screening, dosing, positioning, classification, feeding, loosening, and discharging.

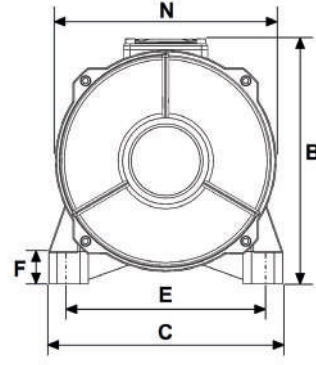
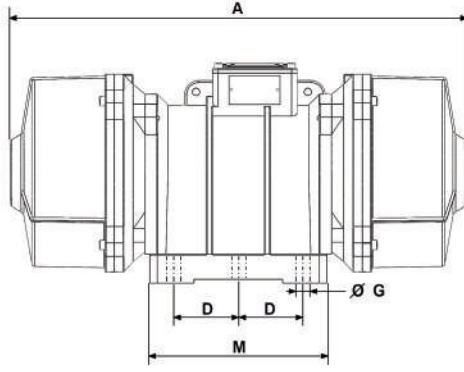

ATEX 22 II 3D Ex tc IIIC T85°C Dc - IP66

FV Series

Model Type	Gövde Size	Gövde Ölçüleri - Overall Dimensions (mm)									
		A	B	C	D	E	Ø G	F	M	N	Rakor Cable gland
FV 10/750	D	490	245	233	140	190	4 X M16	33	190	209	M20 X 1,5
FV 10/810	D	500	245	233	140	190	4 X M16	33	190	209	M20 X 1,5
FV 10/1100	D	570	245	233	140	190	4 X M16	33	190	209	M20 X 1,5
FV 10/1700	E0	560	260	271	155	225	4 X M20	68	204	244	M25 X 1,5
FV 10/2000	E0	650	260	271	155	225	4 X M20	68	204	244	M25 X 1,5
FV 10/2600	E	720	283	297	155	255	4 X M20	68	208	255	M25 X 1,5
FV 10/3800	F	855	345	385	100 X 2	320	4 X M27	50	270	345	M25 X 1,5
FV 10/4500	F	855	345	385	100 X 2	320	4 X M27	50	270	345	M25 X 1,5
FV 10/5000	F	855	345	385	100 X 2	320	4 X M27	50	270	345	M25 X 1,5
FV 10/5700	F	855	345	385	100 X 2	320	4 X M27	50	270	345	M25 X 1,5
FV 10/6000	F	855	345	385	100 X 2	320	4 X M27	50	270	345	M25 X 1,5
FV 10/6500	F	855	345	385	100 X 2	320	4 X M27	50	270	345	M25 X 1,5
FV 10/7000	F	855	345	385	100 X 2	320	4 X M27	50	270	345	M25 X 1,5
FV 10/8500	G	930	390	470	125 X 2	380	4 X M36	38	370	385	M25 X 1,5
FV 10/10000	G	930	390	470	125 X 2	380	4 X M36	38	370	385	M25 X 1,5

AC 1 Phase : 230V - 50 Hz

Rpm : 3000 Rpm

Safety Class : IP66

Insulation Class : F

Casing : Aluminum



ATEX 22 II 3D Ex tc IIIC T85°C Dc - IP66

FV-M Series

Model Type	Gövde Size	Statik Moment Static Moment	Santrifüj Kuvveti Centrifugal Force		Ağırlık Weight	Giriş Gücü Input Power	Nominal Akım Nom. Current
		kgmm	kgF	kN	kg	kW	A
FV-M 3/65	A0	6,4	64	0,63	6,1	0,15	0,60
FV-M 3/100	A0	10,3	103	1,01	6,2	0,15	0,60
FV-M 3/130	A0	13,7	138	1,36	6,5	0,18	0,75
FV-M 3/200	A0	19,9	200	1,97	6,6	0,18	0,75
FV-M 3/300	A	29,8	300	2,95	7,8	0,25	1,00
FV-M 3/400	A	39,9	402	3,95	8,6	0,37	1,50
FV-M 3/500	B	49,7	500	4,91	10,8	0,45	2,00

Working Moment = 2 X Static Moment

FV-M Serisi 3000 rpm. Vibrasyon motorları beton sıkıştırma, betonierler, filtre temizleme, gevşetme, boşaltma, ayıklama, dozajlama gibi titreşim hareketinin gerektiği tüm alanlarda kullanılır.

FV Series 3000 rpm vibration motors are used in all areas where vibration motion is required, such as concrete compaction, concrete mixers, filter cleaning, loosening, discharging, sorting, and dosing.

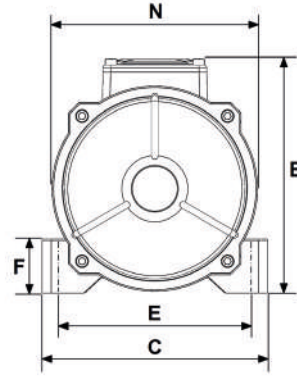
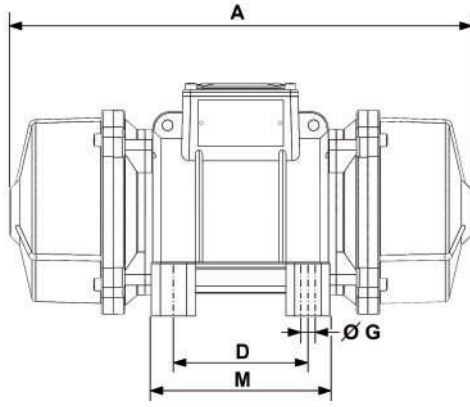

ATEX 22 II 3D Ex tc IIIC T85°C Dc - IP66

FV-M Series

Model Type	Gövde Size	Gövde Ölçüleri - Overall Dimensions (mm)									
		A	B	C	D	E	Ø G	F	M	N	Rakor Cable gland
FV-M 3/65	A0	222	161	126	62-74	106	4 X M8	15	103	120	M16 X 1,5
FV-M 3/100	A0	222	161	126	62-74	106	4 X M8	15	103	120	M16 X 1,5
FV-M 3/130	A0	222	161	126	62-74	106	4 X M8	15	103	120	M16 X 1,5
FV-M 3/200	A0	222	161	126	62-74	106	4 X M8	15	103	120	M16 X 1,5
FV-M 3/300	A	255	159	155	90	125	4 X M12	36	122	135	M20 X 1,5
FV-M 3/400	A	255	159	155	90	125	4 X M12	36	122	135	M20 X 1,5
FV-M 3/500	B	318	184	175	105	140	4 X M12	42	140	160	M20 X 1,5

AC 1 Phase : 230V - 50 Hz

Rpm : 1500 Rpm

Safety Class : IP66

Insulation Class : F

Casing : Aluminum



ATEX 22 II 3D Ex tc IIIC T85°C Dc - IP66

FV-M Series

Model Type	Gövde Size	Statik Moment Static Moment	Santrifüj Kuvveti Centrifugal Force		Ağırlık Weight	Giriş Gücü Input Power	Nominal Akım Nom. Current
		kgmm	kgF	kN	kg	kW	A
FV-M 15/20	A0	9,9	25	0,25	7,4	0,09	0,38
FV-M 15/30	A0	13,5	34	0,34	7,4	0,09	0,38
FV-M 15/60	A0	24,2	61	0,60	7,4	0,09	0,40
FV-M 15/90	A	33,4	93	0,92	7,5	0,09	0,42
FV-M 15/200	B	67,1	169	1,66	12	0,18	0,80

Working Moment = 2 X Static Moment

FV-M Serisi 1500 rpm. Vibrasyon motorları ayırma, yükleme, eleme, dozajlama, konumlama, sınıflandırma, besleme, gevşetme, boşaltma gibi titreşim hareketinin gerektiği tüm alanlarda kullanılır.

FV Series 1500 rpm vibration motors are used in all areas where vibration motion is required, such as separation, loading, screening, dosing, positioning, classification, feeding, loosening, and discharging.

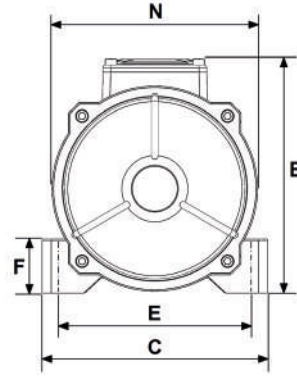
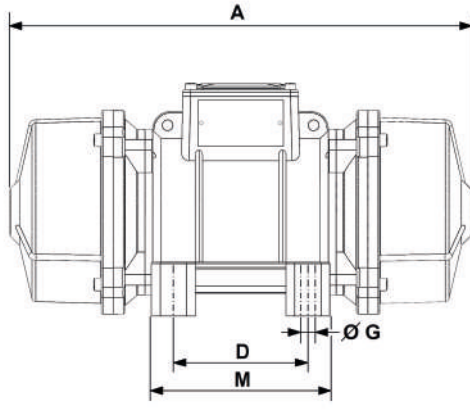

ATEX 22 II 3D Ex tc IIIC T85°C Dc - IP66

FV-M Series

Model Type	Gövde Size	Gövde Ölçüleri - Overall Dimensions (mm)									
		A	B	C	D	E	Ø G	F	M	N	Rakor Cable gland
FV-M 15/20	A0	222	161	126	62-74	106	4 X M8	15	103	120	M16 X 1,5
FV-M 15/30	A0	222	161	126	62-74	106	4 X M8	15	103	120	M16 X 1,5
FV-M 15/60	A0	222	161	126	62-74	106	4 X M8	15	103	120	M16 X 1,5
FV-M 15/90	A	296	159	155	90	125	4 X M12	36	122	135	M20 X 1,5
FV-M 15/200	B	318	184	175	105	140	4 X M12	42	140	160	M20 X 1,5



**FVF
SERIES**

2025

**Femas Vibration Motors
Catalogue**



Model Type	Gövde Size	Statik Moment Static Moment	Santrifüj Kuvveti Centrifugal Force		Ağırlık Weight	Giriş Gücü Input Power	Nominal Akım Nom. Current
		kgmm	kgF	kN	kg	kW	A
		50 Hz	50 Hz	50 Hz	50 Hz	50 Hz	400 V 50 Hz
FVF 3/130	FA	13,7	138	1,36	7,9	0,18	0,35
FVF 3/200	FA	19,9	200	1,97	8	0,18	0,35
FVF 3/300	FA	29,8	300	2,95	8,5	0,25	0,60
FVF 3/400	FA	39,9	402	3,95	9	0,37	0,70
FVF 3/500	FB	49,7	500	4,91	13	0,45	0,80
FVF 3/650	FB	66	665	6,53	13,7	0,50	0,98
FVF 3/760	FB	77,3	778	7,64	14	0,55	1,00
FVF 3/850	FC	85,5	861	8,45	27	0,60	1,20
FVF 3/950	FC	94,2	948	9,30	27,6	0,65	1,30
FVF 3/1100	FC	102,9	1037	10,18	28	0,75	1,50
FVF 3/1300	FC	129,1	1300	12,76	29	1,1	1,75
FVF 3/1600	FD	163,4	1645	16,14	30	1,5	2,30
FVF 3/1800	FD	179,8	1810	17,76	36	2	2,60
FVF 3/2000	FD	195,6	1970	19,33	38	2,2	3,30
FVF 3/2300	FD	224,6	2262	22,19	40	2,4	3,50

Working Moment = 2 X Static Moment



Model Type	Gövde Size	Gövde Ölçüleri - Overall Dimensions (mm)							
		A	Ø B	Ø C	Ø D	Ø H	G	M	Cable Entry
FVF 3/130	FA	225	180	135	150	4 X M8	12	55	M16 X 1,5
FVF 3/200	FA	225	180	135	150	4 X M8	12	55	M16X 1,5
FVF 3/300	FA	230	180	135	150	4 X M8	12	55	M16 X 1,5
FVF 3/400	FA	235	180	135	150	4 X M8	12	55	M16 X 1,5
FVF 3/500	FB	285	180	135	150	4 X M8	12	55	M20 X 1,5
FVF 3/650	FB	285	180	135	150	4 X M8	12	55	M20 X 1,5
FVF 3/760	FB	285	180	135	150	4 X M8	12	55	M20 X 1,5
FVF 3/850	FC	360	260	160	230	6 X M12	23	75	M20 X 1,5
FVF 3/950	FC	360	260	160	230	6 X M12	23	80	M20 X 1,5
FVF 3/1100	FC	360	260	160	230	6 X M12	23	85	M20 X 1,5
FVF 3/1300	FC	365	260	160	230	6 X M12	23	85	M20 X 1,5
FVF 3/1600	FD	380	290	185	250	6 X M16	23	90	M20 X 1,5
FVF 3/1800	FD	380	290	185	250	6 X M16	23	90	M20 X 1,5
FVF 3/2000	FD	380	290	185	250	6 X M16	23	95	M20 X 1,5
FVF 3/2300	FD	380	290	185	250	6 X M16	23	95	M20 X 1,5

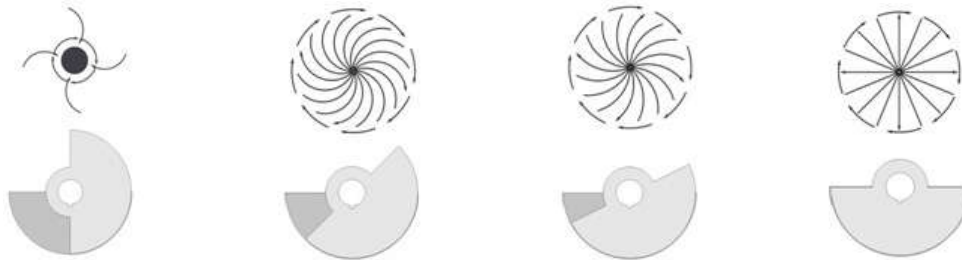
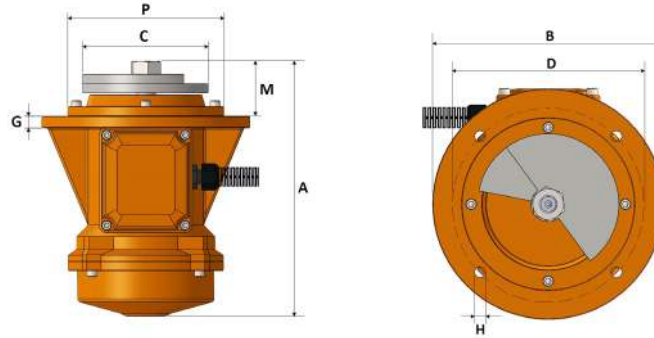

Model Type	Gövde Size	Statik Moment Static Moment	Santrifüj Kuvveti Centrifugal Force		Ağırlık Weight	Giriş Gücü Input Power	Nominal Akım Nom. Current
		kgmm	kgF	kN	kg	kW	A
		50 Hz	50 Hz	50 Hz	50 Hz	50 Hz	400 V 50 Hz
FVF 15/90	FA	33,4	93	0,92	8,5	0,09	0,21
FVF 15/200	FA	67,1	169	1,66	10	0,18	0,42
FVF 15/300	FB	122,2	308	3,02	16	0,27	0,55
FVF 15/400	FB	167	421	4,13	18	0,37	0,70
FVF 15/520	FB	206	519	5,09	21	0,40	0,80
FVF 15/650	FC	259	652	6,4	30	0,45	0,90
FVF 15/750	FC	302	761	7,47	31	0,55	0,95
FVF 15/1300	FD	529	1332	13,07	44	0,75	1,35
FVF 15/1500	FD	605	1524	14,95	46	0,95	1,50
FVF 15/1800	FD	681	1715	17,59	49	1,1	2,00
FVF 15/7000	FF	2780	7005	68,72	168	5,5	10,50

Working Moment = 2 X Static Moment

Model Type	Gövde Size	Statik Moment Static Moment	Santrifüj Kuvveti Centrifugal Force		Ağırlık Weight	Giriş Gücü Input Power	Nominal Akım Nom. Current
		kgmm	kgF	kN	kg	kW	A
		50 Hz	50 Hz	50 Hz	50 Hz	50 Hz	400 V 50 Hz
FVF 10/750	FD	682	763	7,49	51	0,55	1,00
FVF 10/1100	FD	909	1018	9,99	57	0,75	1,45

Working Moment = 2 X Static Moment



Model Type	Gövde Size	Gövde Ölçüleri - Overall Dimensions (mm)							
		A	Ø B	Ø C	Ø D	Ø H	G	M	Cable Entry
FVF 15/90	FA	230	180	135	150	4 X M8	12	80	M16 X 1,5
FVF 15/200	FA	270	180	135	150	4 X M8	12	80	M16 X 1,5
FVF 15/300	FB	300	180	135	150	4 X M8	12	85	M16 X 1,5
FVF 15/400	FB	330	180	135	150	4 X M8	12	105	M16 X 1,5
FVF 15/520	FB	300	180	135	150	4 X M8	12	125	M16 X 1,5
FVF 15/650	FC	428	260	160	230	6 X M12	23	125	M20 X 1,5
FVF 15/750	FC	428	260	160	230	6 X M12	23	125	M20 X 1,5
FVF 15/1300	FD	445	290	185	250	6 X M16	23	120	M20 X 1,5
FVF 15/1500	FD	475	290	185	250	6 X M16	23	125	M20 X 1,5
FVF 15/1800	FD	475	290	185	250	6 X M16	23	130	M20 X 1,5
FVF 15/7000	FF	615	555	400	495	8 X M29	35	190	M25 X 1,5

Model Type	Gövde Size	Gövde Ölçüleri - Overall Dimensions (mm)							
		A	Ø B	Ø C	Ø D	Ø H	G	M	Cable Entry
FVF 10/750	FD	405	290	185	250	6 X M16	23	120	M20 X 1,5
FVF 15/1000	FD	430	290	185	250	6 X M16	23	130	M20 X 1,5

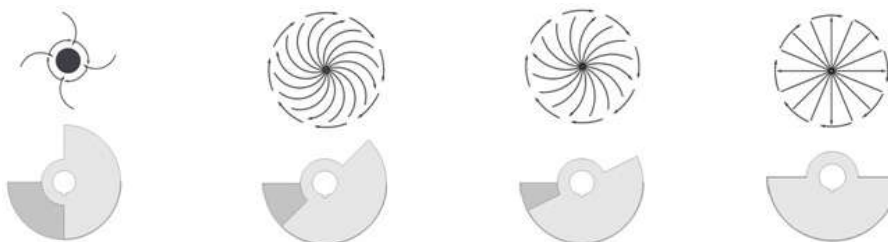
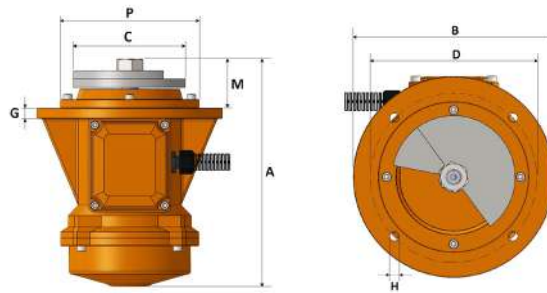

Model Type	Gövde Size	Statik Moment Static Moment	Santrifüj Kuvveti Centrifugal Force		Ağırlık Weight	Giriş Gücü Input Power	Nominal Akım Nom. Current
		kgmm	kgF	kN	kg	kW	A
		50 Hz	50 Hz	50 Hz	50 Hz	50 Hz	400 V 50 Hz
FVF-M 3/65	FA	6,4	64	0,63	7	0,15	0,60
FVF-M 3/100	FA	10,3	103	1,01	7,2	0,15	0,60
FVF-M 3/130	FA	13,7	138	1,36	7,3	0,18	0,75
FVF-M 3/200	FA	19,9	200	1,97	7,4	0,18	0,75
FVF-M 3/300	FA	29,8	300	2,95	7,6	0,25	1,00
FVF-M 3/400	FA	39,9	402	3,95	9	0,37	1,50
FVF-M 3/500	FB	49,7	500	4,91	12	0,45	2,00

Working Moment = 2 X Static Moment

Model Type	Gövde Size	Statik Moment Static Moment	Santrifüj Kuvveti Centrifugal Force		Ağırlık Weight	Giriş Gücü Input Power	Nominal Akım Nom. Current
		kgmm	kgF	kN	kg	kW	A
		50 Hz	50 Hz	50 Hz	50 Hz	50 Hz	400 V 50 Hz
FVF-M 15/20	FA	9,9	25	0,25	7,2	0,09	0,20
FVF-M 15/30	FA	13,5	34	0,34	7,3	0,09	0,20
FVF-M 15/60	FA	24,2	61	0,60	7,4	0,09	0,21
FVF-M 15/90	FA	33,4	93	0,92	7,5	0,09	0,21
FVF-M 15/200	FA	67,1	169	1,66	10	0,18	0,42

Working Moment = 2 X Static Moment



AC 1 FAZ / PHASE 230V

2 poles 3000 rpm



Model Type	Gövde Size	Gövde Ölçüleri - Overall Dimensions (mm)							
		A	Ø B	Ø C	Ø D	Ø H	G	M	Cable Entry
FVF-M 3/65	FA	225	180	135	150	4 X M8	12	55	M16 X 1,5
FVF-M 3/100	FA	225	180	135	150	4 X M8	12	55	M16X 1,5
FVF-M 3/130	FA	225	180	135	150	4 X M8	12	55	M16 X 1,5
FVF-M 3/200	FA	225	180	135	150	4 X M8	12	55	M16 X 1,5
FVF-M 3/300	FA	230	180	135	150	4 X M8	12	60	M16 X 1,5
FVF-M 3/400	FA	235	180	135	150	4 X M8	12	70	M16 X 1,5
FVF-M 3/500	FB	285	180	135	150	4 X M8	12	55	M20 X 1,5

AC 1 FAZ / PHASE 230V

4 poles 1500 rpm



Model Type	Gövde Size	Gövde Ölçüleri - Overall Dimensions (mm)							
		A	Ø B	Ø C	Ø D	Ø H	G	M	Cable Entry
FVF-M 15/20	FA	225	180	135	150	4 X M8	12	80	M16 X 1,5
FVF-M 15/30	FA	225	180	135	150	4 X M8	12	80	M16 X 1,5
FVF-M 15/60	FA	225	180	135	150	4 X M8	12	80	M16 X 1,5
FVF-M 15/90	FA	230	180	135	150	4 X M8	12	80	M16 X 1,5
FVF-M 15/200	FA	270	180	135	150	4 X M8	12	80	M16 X 1,5

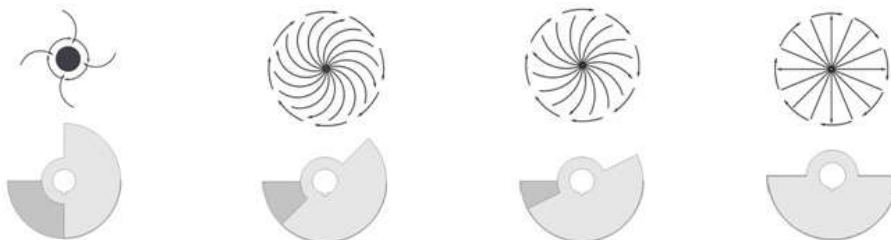
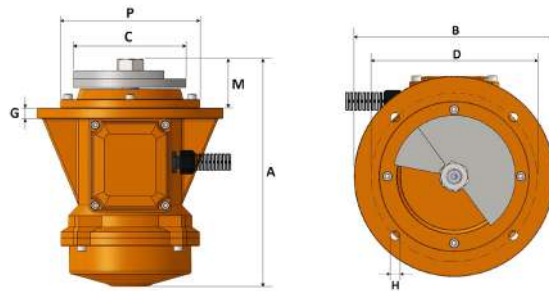

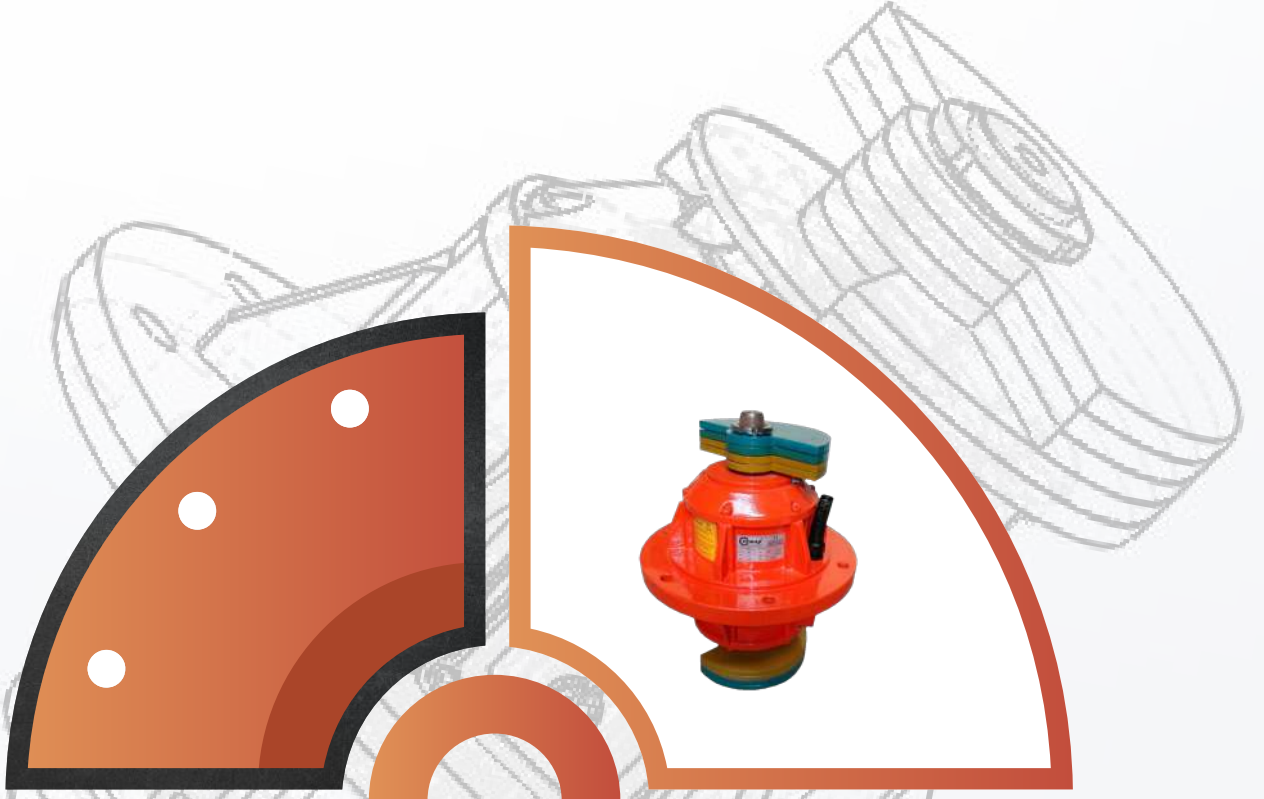

**FVGF
SERIES**

2025

**Femas Vibration Motors
Catalogue**



Model Type	Gövde Size	Statik Moment Static Moment	Santrifüj Kuvveti Centrifugal Force		Ağırlık Weight	Giriş Gücü Input Power	Nominal Akım Nom. Current
		kgmm	kgF	kN	kg	kW	A
		50 Hz	50 Hz	50 Hz	50 Hz	50 Hz	400 V 50 Hz
FVGF 3/2500	FE0	263,9	2260	26,10	88	2,5	3,80
FVGF 3/3300	FE0	331,8	3344	32,81	90	3	4,50
FVGF 3/4000	FE	399,4	4022	39,46	140	4	6,50
FVGF 3/6500	FF	613,6	6565	64,41	160	7,5	12,50
FVGF 3/7600	FF	683,2	7310	71,72	176	9,00	15,00

Working Moment = 2 X Static Moment

Model Type	Gövde Size	Gövde Ölçüleri - Overall Dimensions (mm)									
		A	Ø B	Ø C	Ø D	E	F	Ø H	G	I°	Cable Entry
FVGF 3/2500	FE0	475	400	310	355	145	115	6 X M20	30	*	M20 X 1,5
FVGF 3/3300	FE0	475	400	310	355	145	115	6 X M20	30	*	M20 X 1,5
FVGF 3/4000	FE	475	400	310	355	145	115	6 X M20	30	*	M20 X 1,5
FVGF 3/6500	FF	545	508	350	438	190	158	8 X M27	32	30°	M20 X 1,5
FVGF 3/7600	FF	565	508	350	438	190	158	8 X M27	32	30°	M20 X 1,5

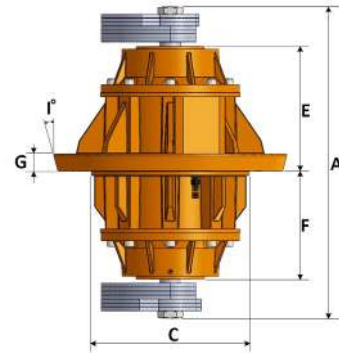
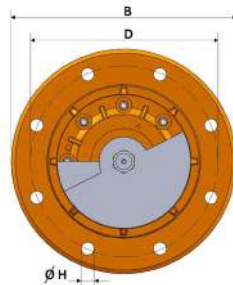
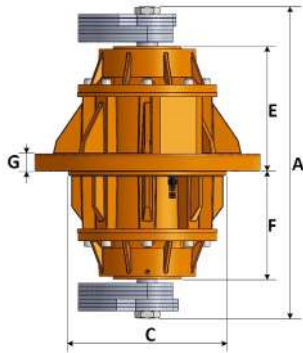

Model Type	Gövde Size	Statik Moment Static Moment	Santrifüj Kuvveti Centrifugal Force		Ağırlık Weight	Giriş Gücü Input Power	Nominal Akım Nom. Current
		kgmm	kgF	kN	kg	kW	A
		50 Hz	50 Hz	50 Hz	50 Hz	50 Hz	400 V 50 Hz
FVGF 15/2450	FE0	940	2368	23,23	90	1,5	2,60
FVGF 15/2700	FE0	1055	2660	26,10	97	1,7	3,20
FVGF 15/3800	FE	1543	3888	38,14	154	2,2	3,90
FVGF 15/4300	FE	1698	4278	41,97	165	3	5,10
FVGF 15/6000	FF	2383	6003	58,89	180	4	7,60
FVGF 15/7000	FF	2780	7005	68,72	189	5,5	10,50
FVGF 15/7900	FG	3206	8079	79,25	300	7	11,60
FVGF 15/9500	FG	3742	9428	92,49	380	7,5	12,20

Working Moment = 2 X Static Moment

Model Type	Gövde Size	Gövde Ölçüleri - Overall Dimensions (mm)									
		A	Ø B	Ø C	Ø D	E	F	Ø H	G	I°	Cable Entry
FVGF 15/2450	FE0	558	350	270	310	178	143	6 X M20	27	*	M20 X 1,5
FVGF 15/2700	FE0	578	350	270	310	178	143	6 X M20	27	*	M20 X 1,5
FVGF 15/3800	FE	635	400	310	355	145	115	6 X M20	30	*	M20 X 1,5
FVGF 15/4300	FE	655	400	310	355	145	115	6 X M20	30	*	M20 X 1,5
FVGF 15/6000	FF	690	508	350	438	190	158	8 X M27	32	30°	M20 X 1,5
FVGF 15/7000	FF	710	508	350	438	190	158	8 X M27	32	30°	M20 X 1,5
FVGF 15/7900	FG	715	590	400	495	215	172	8 X M36	43	15°	M20 X 1,5
FVGF 15/9500	FG	855	650	500	560	215	165	8 X M36	50	15°	M20 X 1,5

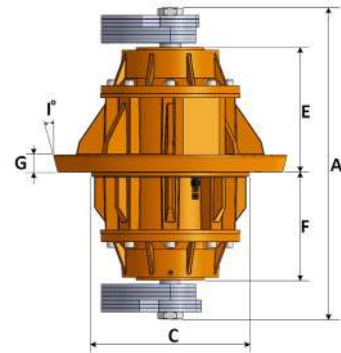
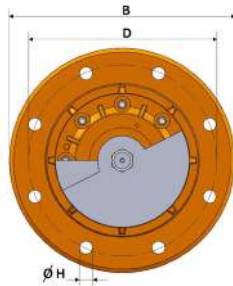
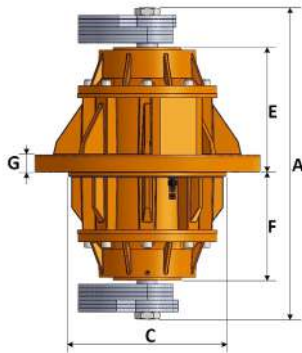

Model Type	Gövde Size	Statik Moment Static Moment	Santrifüj Kuvveti Centrifugal Force		Ağırlık Weight	Giriş Gücü Input Power	Nominal Akım Nom. Current
		kgmm	kgF	kN	kg	kW	A
		50 Hz	50 Hz	50 Hz	50 Hz	50 Hz	400 V 50 Hz
FVGF 10/1700	FE0	1481	1658	16,26	120	1,1	2,20
FVGF 10/2600	FE	2317	2595	25,52	155	2	4,35
FVGF 10/3800	FF	3359	3762	36,91	195	2,3	4,60
FVGF 10/4500	FF	3920	4390	46,16	255	3	7,50

Working Moment = 2 X Static Moment

Model Type	Gövde Size	Gövde Ölçüleri - Overall Dimensions (mm)									
		A	Ø B	Ø C	Ø D	E	F	Ø H	G	I°	Cable Entry
FVGF 10/1700	FE0	475	400	310	355	160	150	6 X M20	30	*	M20 X 1,5
FVGF 10/2600	FE	475	400	310	355	160	150	6 X M20	30	*	M20 X 1,5
FVGF 10/3800	FF	545	508	350	438	205	208	8 X M27	32	30°	M20 X 1,5
FVGF 10/4500	FF	850	508	350	438	205	208	8 X M27	32	30°	M20 X 1,5

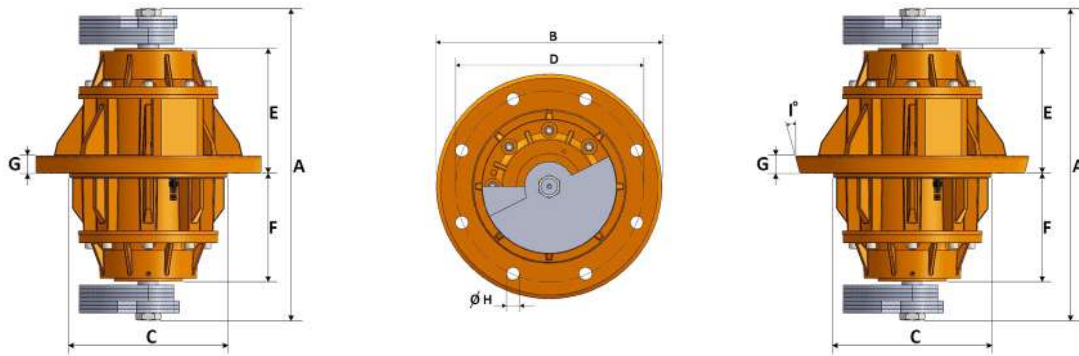

UYGULAMALARA GÖRE VİBRASYON MOTORU SEÇİMİ

Frekans, genlik, çalışma momenti, merkezkaç kuvveti ve ivme vibrasyon motorunun sahip olduğu teknik değerlerdir. Uygulamalara bağlı olarak bu teknik veriler göz önünde bulundurulmalıdır. Bir adet vibrasyon motoru kullanımı ile dairesel, iki adet kullanım ile doğrusal hareket elde edilir.

VIBRATION MOTOR SELECTION ACCORDING TO APPLICATIONS

Frequency, amplitude, working moment, centrifugal force, and acceleration are the technical specifications of a vibration motor. These technical parameters should be taken into consideration depending on the application. Circular motion is achieved with a single vibration motor, while linear motion is achieved using two vibration motors.

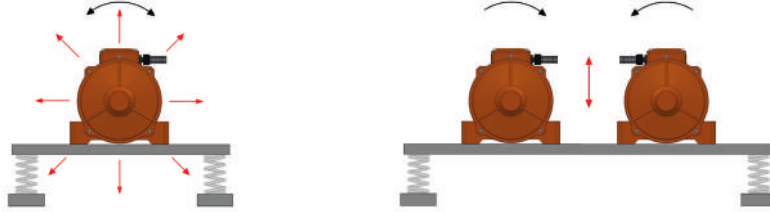

UYGULAMALAR APPLICATION	FREKANS FREQUENCY	İVME ACCELERATION	GENLİK AMPLITUDE	VİBRASYON DOĞRULTUSU VIBRATION DIRECTION
Besleme, Dozajlama Feeding, Dosaging	1000-1500	2,0-3,5	Büyük Big	Doğrusal Linear
Eleme Sieving	1000-1500	3,0-4,0	Büyük Big	Doğrusal Linear
Filtre Temizleme Filter Cleaning	1500-3000	3,5-5,0	Orta Medium	Doğrusal Linear
Silo İçi Boşaltım Silo Excretion	1500-3000	Malzemenin %20'si %20 of material	Orta Medium	Dairesel Circular
Sıkıştırma Pressing	1500-6000	2,0-4,0	Ufak Small	Dairesel-Doğrusal Circular-Linear
Beton Sıkıştırma Concrete Pressing	3000-9000	0,8-1,15	Çok Ufak Too Small	Dairesel-Doğrusal Circular-Linear
Test Masası Testing Table	300-6600	0,5-5,0	Ufak-Büyük Small-Big	Dairesel-Doğrusal Circular-Linear

Vibrasyonlu kanalların uzunluğuna göre vibrasyon motorunun frekansı seçilir. Vibrasyonlu kanallarda uygulamalara bağlı olarak montaj açısı değişmektedir.

The frequency of the vibration motor is selected based on the length of the vibrating channels. The mounting angle of the vibration motor on vibrating channels varies depending on the application.

VİBRASYON FREKANSI VIBRATION FREQUENCY	KANAL UZUNLUĞU VESSEL LENGHT	SALINIM OSCILLATION	AÇI DEGREE	UYGULAMALAR APPLICATIONS
3000 RPM	3000 mm	0,5 - 2 mm	25 - 35	Besleme, Yükleme, Ayıklama, Dozajlama Feeding, Loading, Seperating, Dosaging
1500 RPM	4800 mm	4 - 6 mm	30 - 45	Eleme, Sınıflandırma, Ayırma Sieving, Classificaiton, Seperation
1000 RPM	6000 mm	6 - 12 mm	45 - 80	Kurutma Drying

1. ÇALIŞMA MOMENTİ / WORKING MOMENT

$$M = s \times m$$

Moment (cmkg) = TOPLAM SALINIM (CM) X AĞIRLIK (KG)

Moment (cmkg) = TOTAL OSCILLATION (CM) X WEIGHT (KG)

2. TOPLAM SALINIM / TOTAL OSCILLATION

$$s = 2 \times \text{GENLİK}$$

TOPLAM SALINIM (CM) = 2 X GENLİK (CM)

TOTAL OSCILLATION (CM) X AMPLITUDE (CM)

3. MERKEZKAÇ KUVVET / CENTRUFUGAL FORCE

$$F = M \times n^2 \times 54,84 / 106$$

KUVVET (N) = ÇALIŞMA MOMENTİ (cmkg) x devir² / 18235

FORCE (N) = WORKING MOMENT (cmkg) x RPM² / 18235

4. MERKEZKAÇ KUVVET / CENTRUFUGAL FORCE

$$F = a (g) \times m \times 9,81$$

KUVVET (N) = İVME (1g) x AĞIRLIK (kg) x 9,81

FORCE (N) = MOMENTUM (1g) x WEIGHT (kg) x 9,81



FEMAŞ ELEKTRİK MOTOR SAN. ve TİC. LTD. ŞTİ.

ASTİM ORG. SAN. BÖL. 3. CAD. NO:6 EFELER / AYDIN / TÜRKİYE

TEL: +90 (256) 231 06 19

FAX: +90 (256) 231 16 19

MOBİL: +90 (555) 860 89 58

E-MAIL: fvm@fvm.com.tr



www.fvm.com.tr